

Central Park, Issaquah
Bike Skills Park Preliminary Design
by Evergreen Mountain Bike Alliance

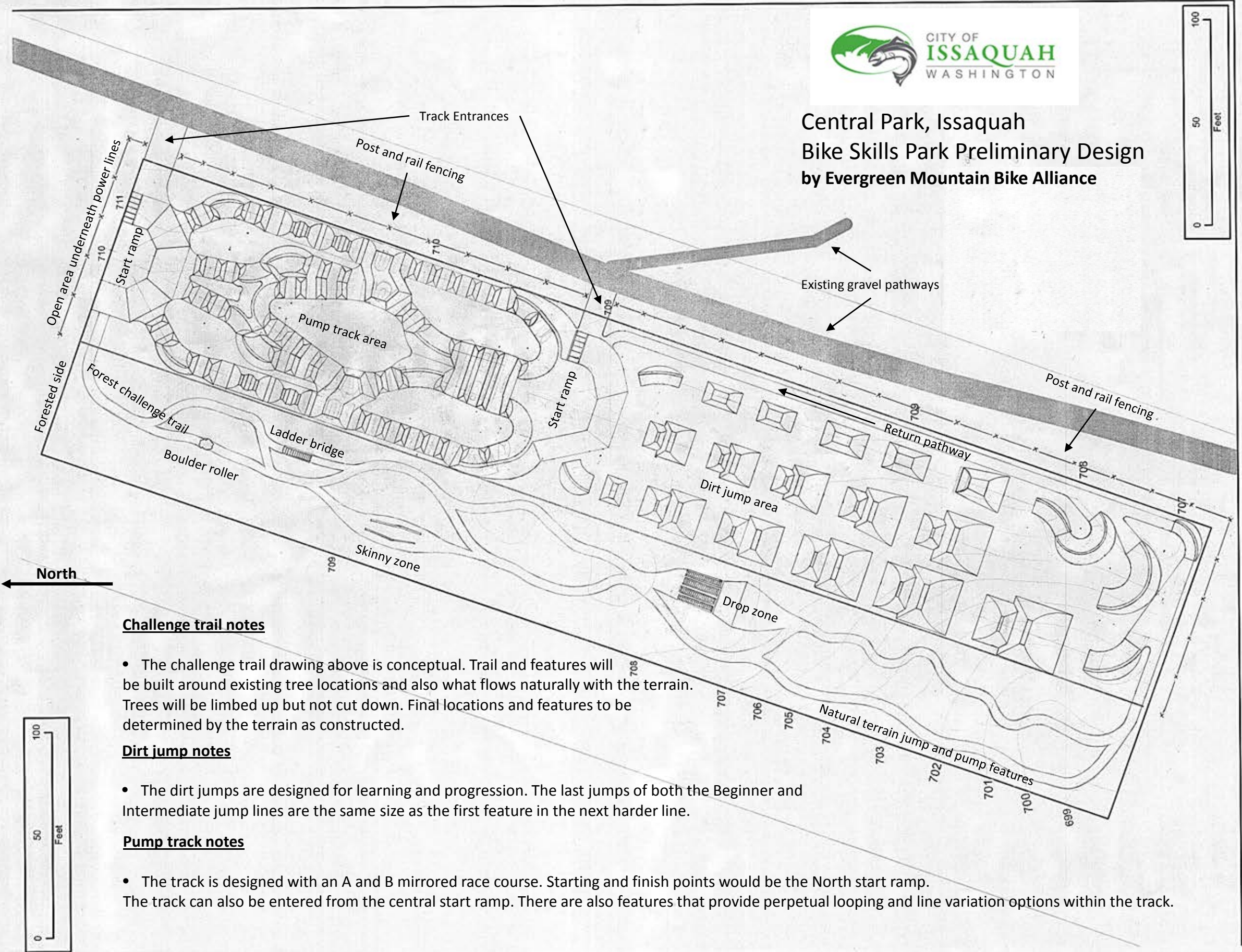

Challenge trail notes

- The challenge trail drawing above is conceptual. Trail and features will be built around existing tree locations and also what flows naturally with the terrain. Trees will be limbed up but not cut down. Final locations and features to be determined by the terrain as constructed.

Dirt jump notes

- The dirt jumps are designed for learning and progression. The last jumps of both the Beginner and Intermediate jump lines are the same size as the first feature in the next harder line.

Pump track notes

- The track is designed with an A and B mirrored race course. Starting and finish points would be the North start ramp. The track can also be entered from the central start ramp. There are also features that provide perpetual looping and line variation options within the track.

